

2no. ADVANCE WARNING SIGNS TO BE INSTALLED PRIOR TO ROAD CLOSURE (DATE/DURATION TBC BY CLIENT)

This Road Will be closed On xx/xx/xx for xxxxxx

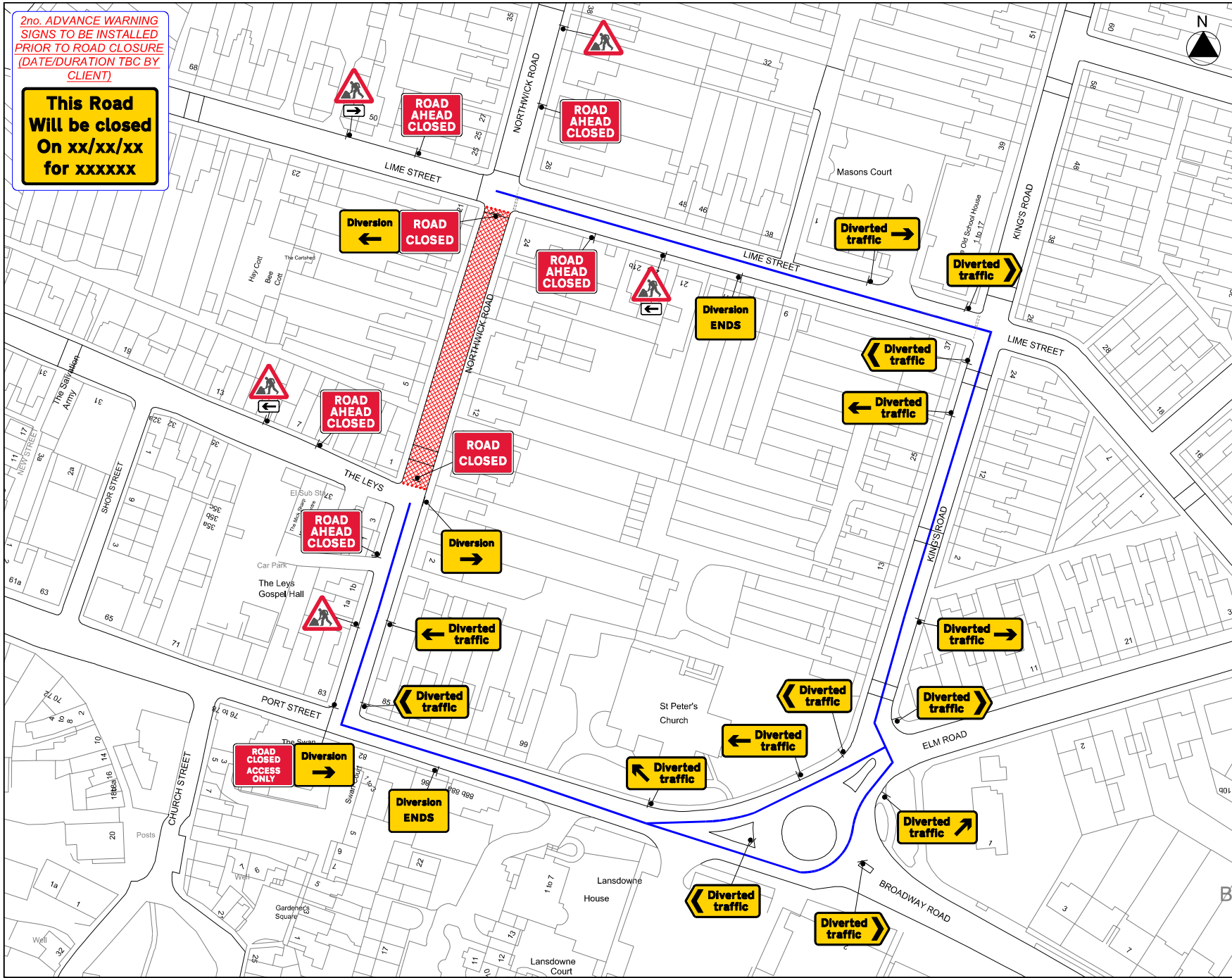

NOTES:

- All traffic signs shall comply with Chapter 6 of the Traffic Signs Manual
- All traffic management equipment shall be provided by the Contractor, unless otherwise specified.
- All signs shall be positioned so as not to be obscured by any other objects and shall not obstruct any other signs, pavement or temporary so much as to be hazardous, practicable.

KEY:

- SIGN
- CLOSED AREA
- DIVERSION

SIGN SCHEDULE:

Qty: 1 Ref: 1048310 Road Closed Access Only	
Qty: 2 Ref: 2702 Start of temporary diversion route	
Qty: 2 Ref: 2703 End of temporary diversion route	
Qty: 1 Ref: 2701 Start of temporary diversion route	
Qty: 3 Ref: 2701 Division of temporary diversion route from junction ahead	
Qty: 1 Ref: 2702 Division of temporary diversion route from junction ahead	
Qty: 1 Ref: 2703 Division of temporary diversion route from junction ahead	
Qty: 1 Ref: 2704 Division of temporary diversion route	
Qty: 1 Ref: 2705 Division of temporary diversion route	
Qty: 1 Ref: 2706 Division of temporary diversion route	
Qty: 1 Ref: 2707 Division of temporary diversion route	
Qty: 1 Ref: 2708 Division of temporary diversion route	
Qty: 1 Ref: 2709 Division of temporary diversion route	
Qty: 1 Ref: 2710 Division of temporary diversion route	
Qty: 1 Ref: 2711 Division of temporary diversion route	
Qty: 1 Ref: 2712 Division of temporary diversion route	
Qty: 1 Ref: 2713 Division of temporary diversion route	
Qty: 1 Ref: 2714 Division of temporary diversion route	
Qty: 1 Ref: 2715 Division of temporary diversion route	
Qty: 1 Ref: 2716 Division of temporary diversion route	
Qty: 1 Ref: 2717 Division of temporary diversion route	
Qty: 1 Ref: 2718 Division of temporary diversion route	
Qty: 1 Ref: 2719 Division of temporary diversion route	
Qty: 1 Ref: 2720 Division of temporary diversion route	
Qty: 1 Ref: 2721 Division of temporary diversion route	
Qty: 1 Ref: 2722 Division of temporary diversion route	
Qty: 1 Ref: 2723 Division of temporary diversion route	
Qty: 1 Ref: 2724 Division of temporary diversion route	
Qty: 1 Ref: 2725 Division of temporary diversion route	
Qty: 1 Ref: 2726 Division of temporary diversion route	
Qty: 1 Ref: 2727 Division of temporary diversion route	
Qty: 1 Ref: 2728 Division of temporary diversion route	
Qty: 1 Ref: 2729 Division of temporary diversion route	
Qty: 1 Ref: 2730 Division of temporary diversion route	
Qty: 1 Ref: 2731 Division of temporary diversion route	
Qty: 1 Ref: 2732 Division of temporary diversion route	
Qty: 1 Ref: 2733 Division of temporary diversion route	
Qty: 1 Ref: 2734 Division of temporary diversion route	
Qty: 1 Ref: 2735 Division of temporary diversion route	
Qty: 1 Ref: 2736 Division of temporary diversion route	
Qty: 1 Ref: 2737 Division of temporary diversion route	
Qty: 1 Ref: 2738 Division of temporary diversion route	
Qty: 1 Ref: 2739 Division of temporary diversion route	
Qty: 1 Ref: 2740 Division of temporary diversion route	
Qty: 1 Ref: 2741 Division of temporary diversion route	
Qty: 1 Ref: 2742 Division of temporary diversion route	
Qty: 1 Ref: 2743 Division of temporary diversion route	
Qty: 1 Ref: 2744 Division of temporary diversion route	
Qty: 1 Ref: 2745 Division of temporary diversion route	
Qty: 1 Ref: 2746 Division of temporary diversion route	
Qty: 1 Ref: 2747 Division of temporary diversion route	
Qty: 1 Ref: 2748 Division of temporary diversion route	
Qty: 1 Ref: 2749 Division of temporary diversion route	
Qty: 1 Ref: 2750 Division of temporary diversion route	
Qty: 1 Ref: 2751 Division of temporary diversion route	
Qty: 1 Ref: 2752 Division of temporary diversion route	
Qty: 1 Ref: 2753 Division of temporary diversion route	
Qty: 1 Ref: 2754 Division of temporary diversion route	
Qty: 1 Ref: 2755 Division of temporary diversion route	
Qty: 1 Ref: 2756 Division of temporary diversion route	
Qty: 1 Ref: 2757 Division of temporary diversion route	
Qty: 1 Ref: 2758 Division of temporary diversion route	
Qty: 1 Ref: 2759 Division of temporary diversion route	
Qty: 1 Ref: 2760 Division of temporary diversion route	
Qty: 1 Ref: 2761 Division of temporary diversion route	
Qty: 1 Ref: 2762 Division of temporary diversion route	
Qty: 1 Ref: 2763 Division of temporary diversion route	
Qty: 1 Ref: 2764 Division of temporary diversion route	
Qty: 1 Ref: 2765 Division of temporary diversion route	
Qty: 1 Ref: 2766 Division of temporary diversion route	
Qty: 1 Ref: 2767 Division of temporary diversion route	
Qty: 1 Ref: 2768 Division of temporary diversion route	
Qty: 1 Ref: 2769 Division of temporary diversion route	
Qty: 1 Ref: 2770 Division of temporary diversion route	
Qty: 1 Ref: 2771 Division of temporary diversion route	
Qty: 1 Ref: 2772 Division of temporary diversion route	
Qty: 1 Ref: 2773 Division of temporary diversion route	
Qty: 1 Ref: 2774 Division of temporary diversion route	
Qty: 1 Ref: 2775 Division of temporary diversion route	
Qty: 1 Ref: 2776 Division of temporary diversion route	
Qty: 1 Ref: 2777 Division of temporary diversion route	
Qty: 1 Ref: 2778 Division of temporary diversion route	
Qty: 1 Ref: 2779 Division of temporary diversion route	
Qty: 1 Ref: 2780 Division of temporary diversion route	
Qty: 1 Ref: 2781 Division of temporary diversion route	
Qty: 1 Ref: 2782 Division of temporary diversion route	
Qty: 1 Ref: 2783 Division of temporary diversion route	
Qty: 1 Ref: 2784 Division of temporary diversion route	
Qty: 1 Ref: 2785 Division of temporary diversion route	
Qty: 1 Ref: 2786 Division of temporary diversion route	
Qty: 1 Ref: 2787 Division of temporary diversion route	
Qty: 1 Ref: 2788 Division of temporary diversion route	
Qty: 1 Ref: 2789 Division of temporary diversion route	
Qty: 1 Ref: 2790 Division of temporary diversion route	
Qty: 1 Ref: 2791 Division of temporary diversion route	
Qty: 1 Ref: 2792 Division of temporary diversion route	
Qty: 1 Ref: 2793 Division of temporary diversion route	
Qty: 1 Ref: 2794 Division of temporary diversion route	
Qty: 1 Ref: 2795 Division of temporary diversion route	
Qty: 1 Ref: 2796 Division of temporary diversion route	
Qty: 1 Ref: 2797 Division of temporary diversion route	
Qty: 1 Ref: 2798 Division of temporary diversion route	
Qty: 1 Ref: 2799 Division of temporary diversion route	
Qty: 1 Ref: 2800 Division of temporary diversion route	

REV: DESCRIPTION: BY: DATE:



CLIENT: FullFibre.

PROJECT: NORTHWICK ROAD WYCHAVON, EVESHAM

POST CODE: WR11 3AW QR CODE: SPEED OF ROAD(S): 30

TITLE: ROAD CLOSURE / DIVERSION

SCALE @ A3: NTS DATE: 20/03/2023 DRAWN BY: PR CHECKED BY: JP REVISION: 002